

UpToDate Access via Arkansas Colleges of Health Education (ACHE)

- 1) Go to <https://library.achehealth.edu/uptodate> or www.uptodate.com/online.
- 2) Select “Log in with OpenAthens”.

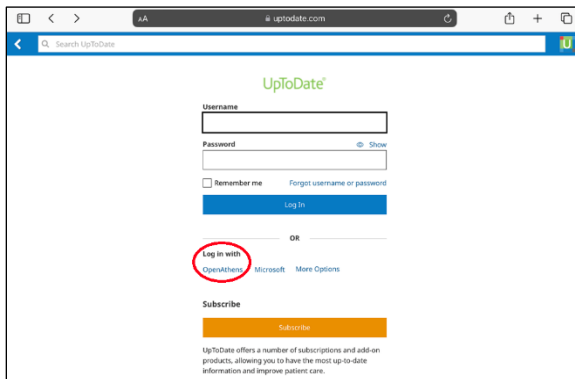

- 3) On the OpenAthens “Find your institution” page, type in and select “Arkansas Colleges of Health Education (ACHE)”.

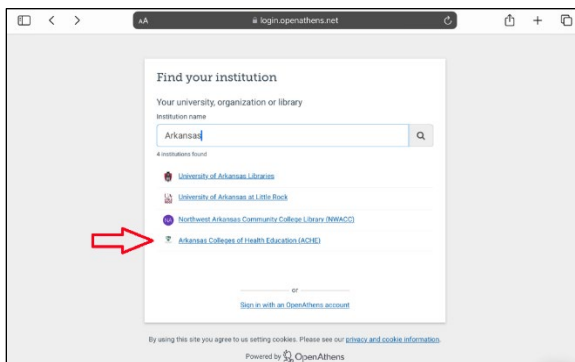

- 4) Select your status from OpenAthens “Choose how to sign in” menu.

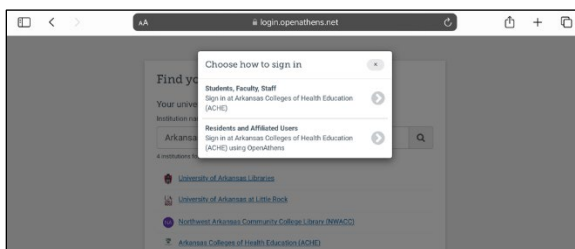

- a. Students, faculty, and staff are directed to the ACHE Federation Services website.

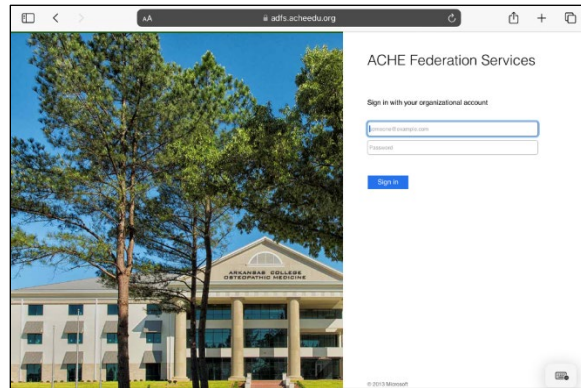

- b. Residents and affiliated users are directed to the ACHE OpenAthens website.

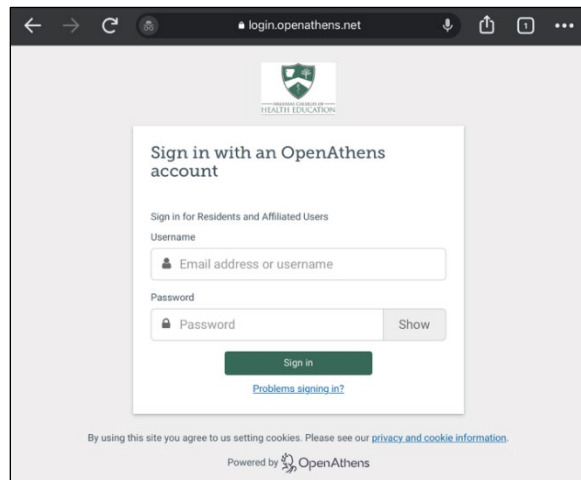

- 5) Once signed in, complete the registration.

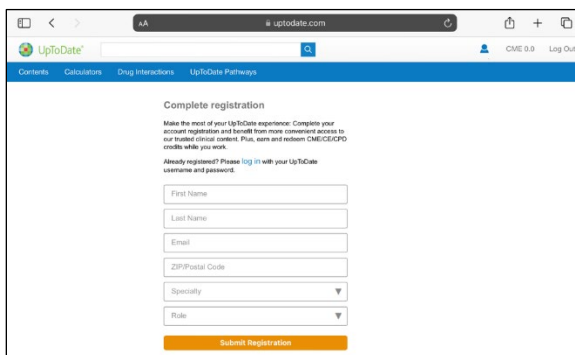

- 6) Once completed, use the same steps to get access via the app. You will not see the registration page.

Questions? Contact your librarians at library@achehealth.edu.